

506 EAST 13TH STREET, NEW YORK, NY 10009

EXCLUSIVE RETAIL LEASE

Brand New, Vanilla Whitebox Space with HVAC

SPACE A - AVAILABLE

SPACE B - LEASED

IPRG



TABLE OF CONTENTS

03 EXECUTIVE SUMMARY

05 LEASE FLOOR PLAN & IMAGES

FOR MORE INFORMATION,
PLEASE CONTACT EXCLUSIVE AGENTS

Brandon Efap

Director of Retail Leasing
718.360.4761
befap@iprg.com

Ravraj Bhullar

Retail Associate
718.360.8951
rbhullar@iprg.com

This information has been secured from sources we believe to be reliable, but we make no representations or warranties, expressed or implied, as to the accuracy of the information. References to square footage, age, zoning, lot size are approximate. Buyer must verify the information and bears all risk for any inaccuracies, including the regulatory status of apartments. Any projections, opinions, assumptions or estimates used herein are for example purposes only and do not represent the current or future performance of the property.

IPRG

EXECUTIVE SUMMARY





SPACE A - AVAILABLE

SPACE B - LEASED

ASK

\$6,250/Month

LEASE HIGHLIGHTS

Approx. 800 SF
Size

9'
Ceiling Heights

25'
Frontage

Immediate
Possession

COMMENTS

- Brand New Vanilla Whitebox Space with HVAC
- Prime East Village Location with Great Foot and Driving Traffic
- Turnkey Retail Space with Great Frontage

FLOOR PLANS

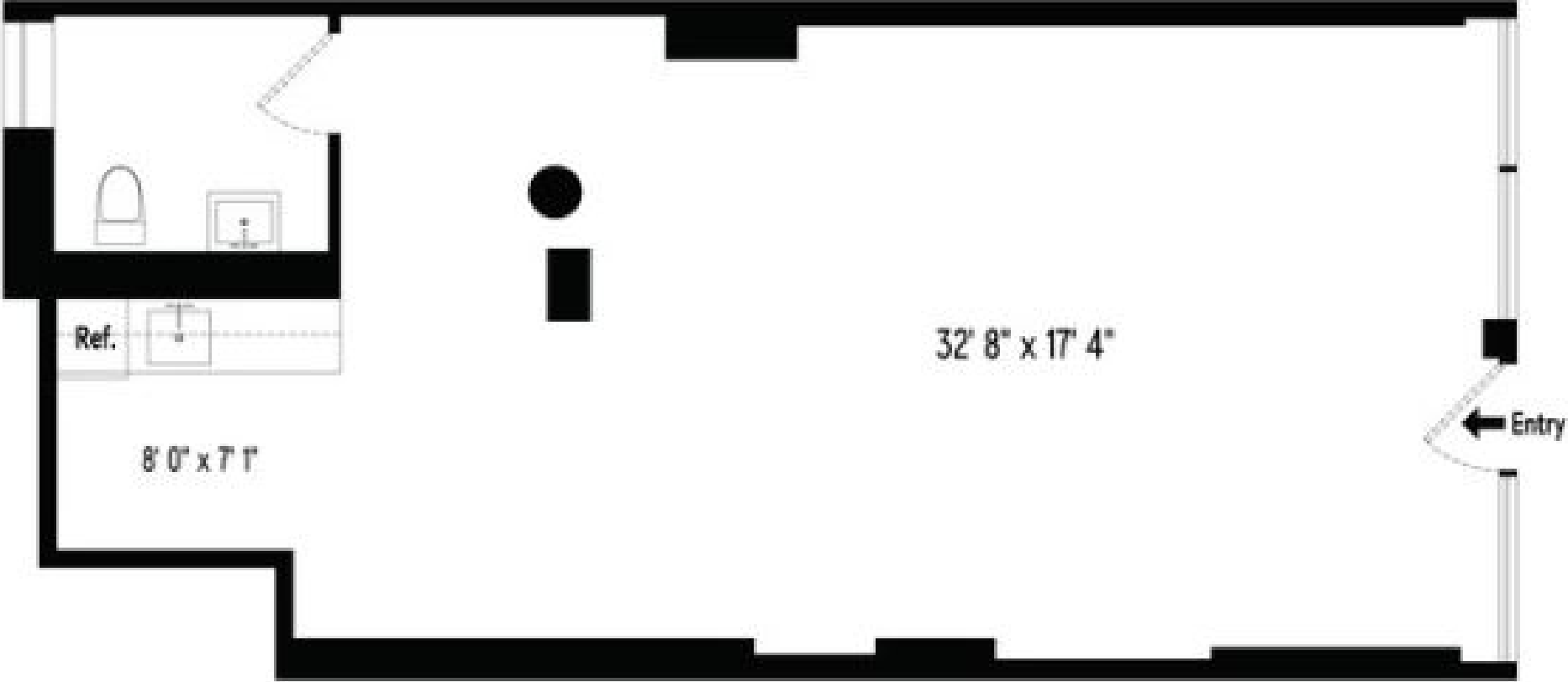

AREA MAP

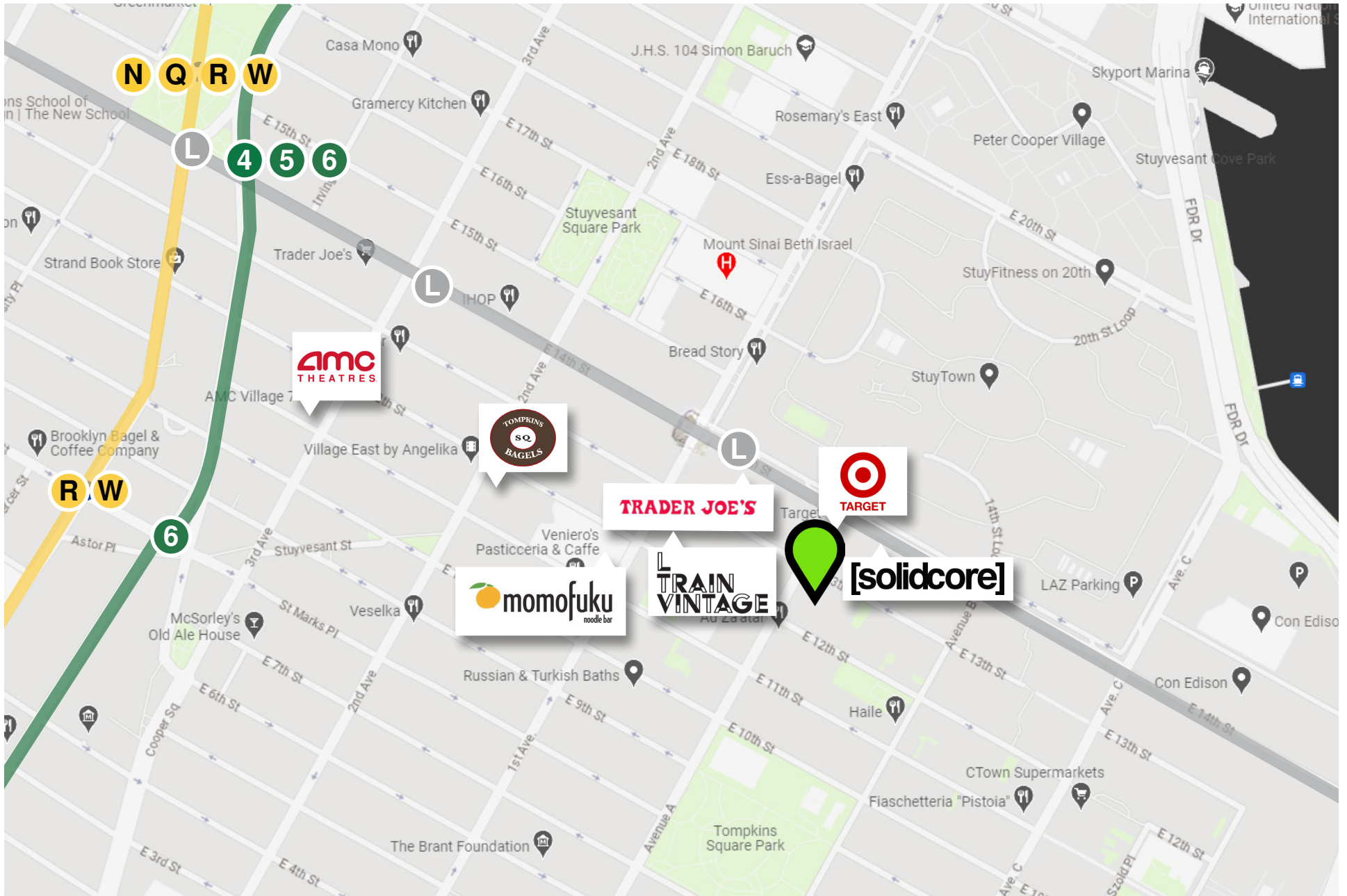

ADDITIONAL PROPERTY PHOTOS



An aerial, black and white photograph of a city, likely New York City, showing a complex highway interchange with multiple lanes and overpasses. The surrounding area is densely packed with buildings of various heights and styles, interspersed with green spaces and trees. The sky is overcast with grey clouds.

IPRG

**506 EAST 13TH STREET
NEW YORK, NY 10009**

**BRANDON
EFAP**
718.360.4761
befap@iprg.com

**RAVRAJ
BHULLAR**
718.360.8951
rbhullar@iprg.com
